

Beneficiar: Bulea Romeo Mircea Sorin
CF 5203, TOP 405/a/1/2/a

P.U.D. - CONSTRUIRE SPALATORIE AUTO

Timisoara, Str. N. Andreescu nr. 63a

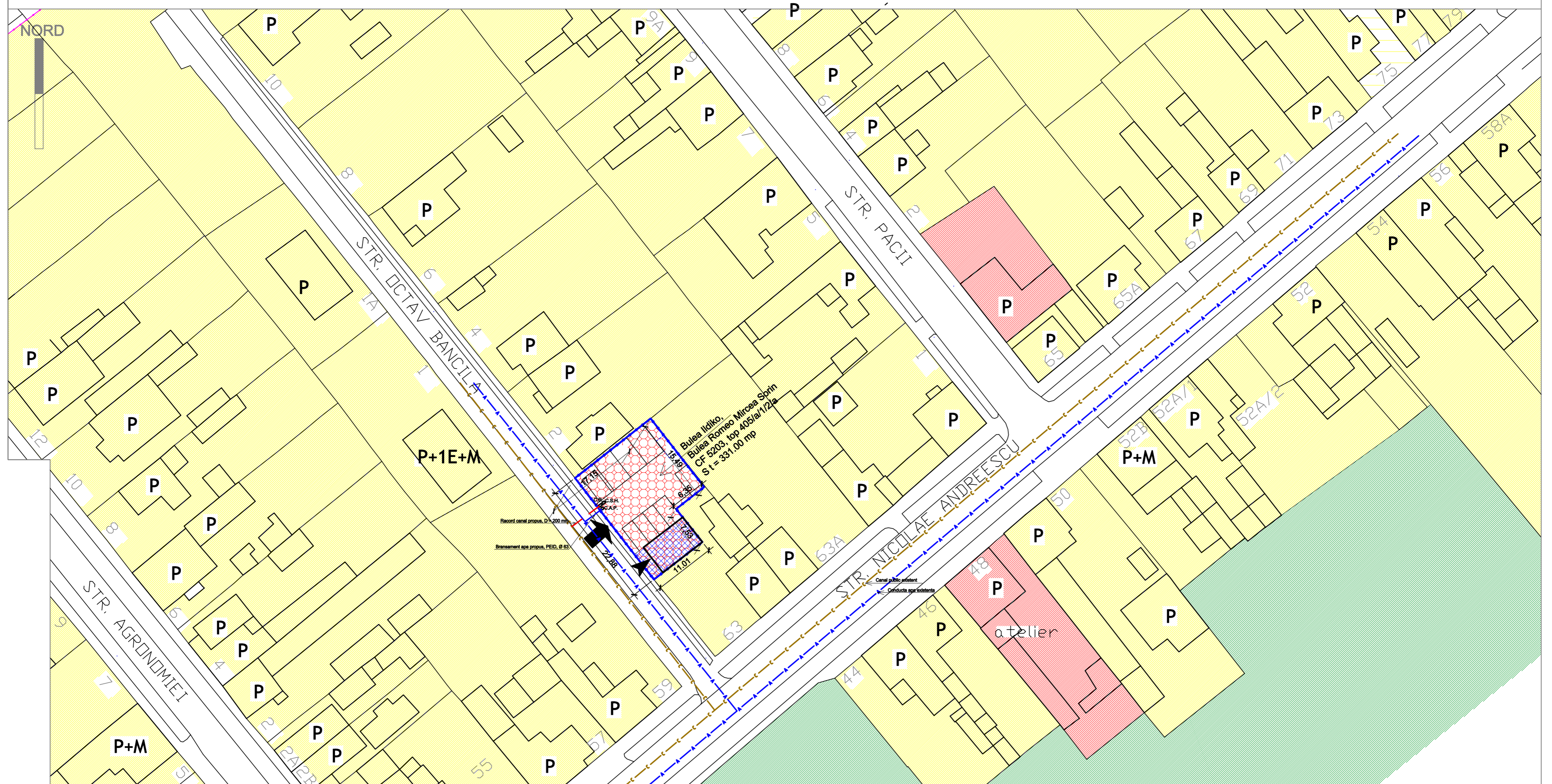

EXISTENT:

- Limita parcelei studiate
 - Aria zonei studiate
 - Acces pe parcela auto+pietonal
 - Locuinte unifamiliale
 - Spatii comerciale si servicii
 - Zona verde
- Indici existent:
St = 331.00 mp
Sc = 6.64 mp
Sd = 6.64 mp
POT existent = 2%
CUT existent = 0.020

PROPOS:

- Spalatorie auto propusa
 - Aria de implantare propusa
 - Acces in constructia propusa
 - Constructie propusa
- Indici propunere:
St = 331.00 mp
Sc = 66.64 mp
Sd = 66.64 mp
POT propus = 20.13%
CUT propus = 0,201
POT max. propus = 30%
CUT max. propus = 0,300

- Conducta apa existenta
- Bransament apa propus, PEID, Ø 63
- Canal public existent
- Racord canal propus, D = 200 mm

BILANT TERITORIAL

	EXISTENT mp	%	PROPOS mp	%
Suprafata teren (St=331mp)				
Spatii verzi	324,36	98	68,75	20,27
Suprafata construita	6,64	2	60,00	18,12
Carosabil in incinta ptr spalatorie	0	0	247,80	74,86

Legenda instalatii:

- CR = camin canalizare de racord propus
- CAP = camin apometru propus
- CSH = camin separator de hidrocarburi
- zv = zona verde aferenta propus, S=27,35mp

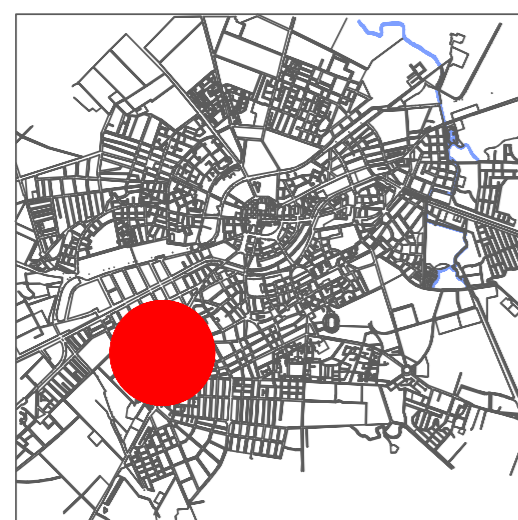

PROIECTANT SC STUDIO ARTPLAN SRL C.U.I. 18440888 STR. C.D. LOGA 40A, TEL. 0356 437891		BENEFICIAR BULEA ROMEO MIRCEA SORIN	PR. NR. 71(9) / 2008
SCARA 1:500		TITLUL PROIECTULUI PLAN URBANISTIC DE DETALIU CONSTRUIRE SPALATORIE AUTO Timisoara, Str. N. Andreescu nr. 63a C.F. nr.5203, top 405/a/1/2/a	FAZA P.U.D.
Sef proiect: arh. ROMEO SZORAD	DATA MAI 2008	TITLUL PLANSEI REGLEMENTARI URBANISTICE	PL. NR. 02