

coordonate stereografice ale punctelor de contur

Nr. Pct.	X [m]	Y [m]
1	480171.799	201958.611
2	479945.827	201967.116
3	479959.651	201926.309
4	479971.140	201899.250
5	479981.185	201854.440
6	479985.536	201830.821
7	479989.543	201799.966
8	479986.548	201763.798
9	479980.486	201737.060
10	479976.184	201716.486
11	479990.115	201720.950
12	480002.957	201726.746
13	480022.493	201737.796
14	480039.341	201751.840
15	480058.541	201772.672
16	480070.912	201781.390
17	480084.695	201786.217
18	480097.529	201797.385
19	480105.019	201811.765
20	480122.395	201848.775
21	480136.334	201880.484
22	480164.216	201941.314

**P.U.Z.**  
**ELABORARE PUZ-ZONA ACTIVITATI PISCICOLE,**  
**CAZARE, SERVICII, AGREMENT, SPORT SI**  
**REALIZARE ACCES (CF. 441953; top 441953)**  
**PLAN SITUATIE EXISTENTA**



480100  
201700

480100  
201900

480100  
202000

Nr cad:441953  
 S=3.18ha

**LUCIU APA**

HS 916/1/2  
 Sact=4.38ha

Legenda:

- luciu apa
- 83.631 cota luciu apa
- taluz piatra
- taluz sus
- constructii existente
- limita teren propus a fi introdus in intravilan
- limita de proprietate

480100  
201700

480000  
201900

480000  
202000

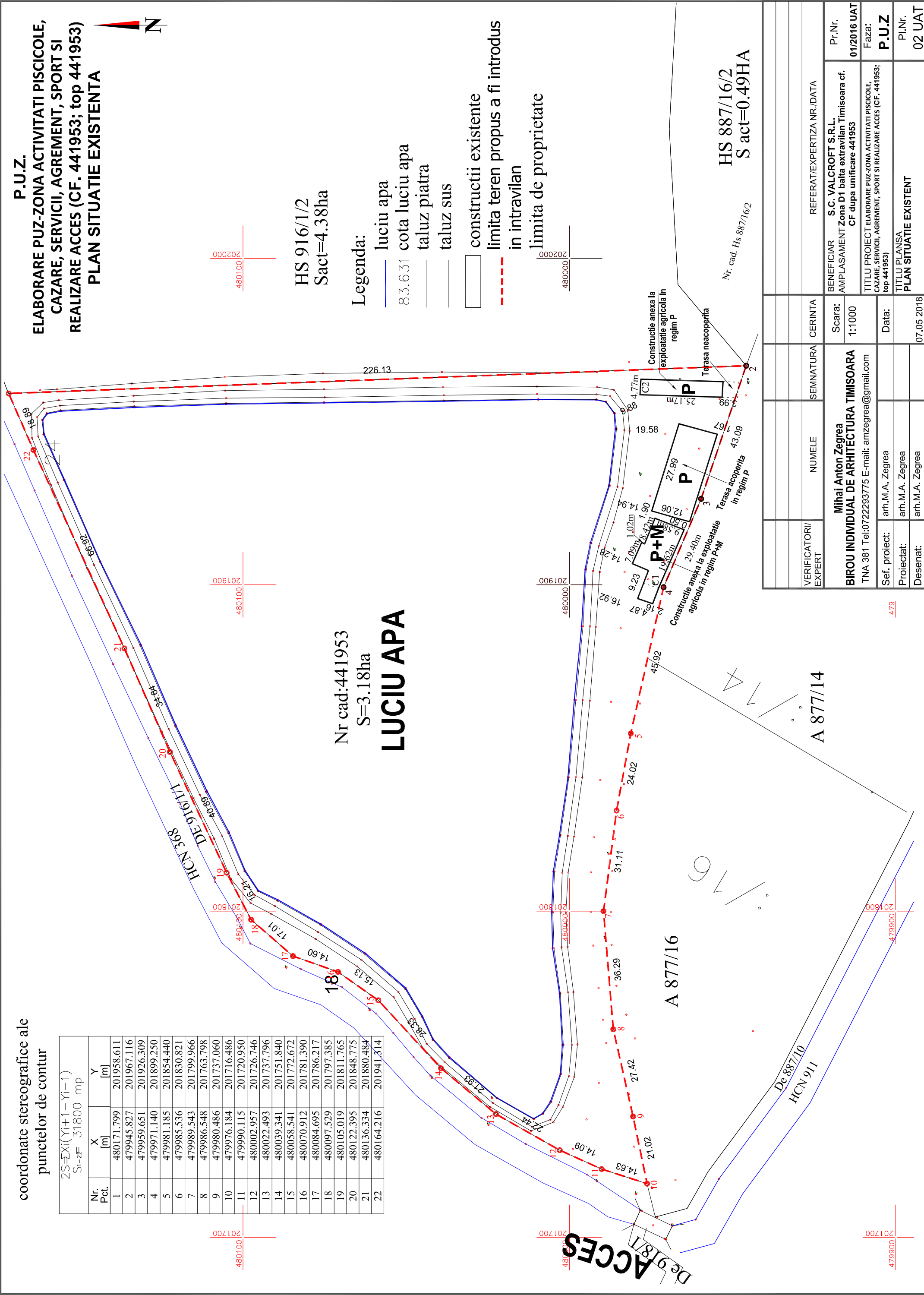

HS 887/16/2  
 S act=0.49HA

Nr. cad. Hs 887/16/2

VERIFICATORI/ EXPERT	NUMELE	SEMNATURA	CERINTA	REFERAT/EXPERTIZA NR./DATA
	Mihai Anton Zegrea		Scara: 1:1000	BENEFICIAR S.C. VALCROFT S.R.L. AMPLASAMENT Zona D1 balta extravilan Timisoara cf. CF dupa unificare 441953
				Pr.Nr. 01/2016 UAT
				Faza: P.U.Z.
			Data: 07.05.2018	TITLU PROIECT ELABORARE PUZ-ZONA ACTIVITATI PISCICOLE, CAZARE, SERVICII, AGREMENT, SPORT SI REALIZARE ACCES (CF. 441953; top 441953)
				TITLU PLANSA PLAN SITUATIE EXISTENT
				Pi.Nr. 02 UAT