

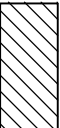



# P.U.D. - SPATIIL COMERCIALE SI LOCUINTE

## Str. Simion Barnutiū nr. 65 - 67

### REGLEMENTARI URBANE

#### LEGENDA

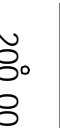
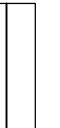
-  LIMITA DE PROPRIETATE = LIMITA ZONEI STUDIATE
-  CLADIRI EXISTENTE
-  ZONA PENTRU LOCUINTE PESTE P+2/ COMERT SI SERVICII
-  LIMITA DE IMPLANTARE A CONSTRUCTIILOR
-  ZONA DE IMPLANTARE A CONSTRUCTIILOR
-  ALINIAMENT PROPOS
-  COTA NIVEL TERN NATURAL
-  DRUMURI PUBLICE EXISTENTE

POT maxim = 70%  
CUT maxim = 3  
REGIM MAXIM DE INALTIME - P+3E+M

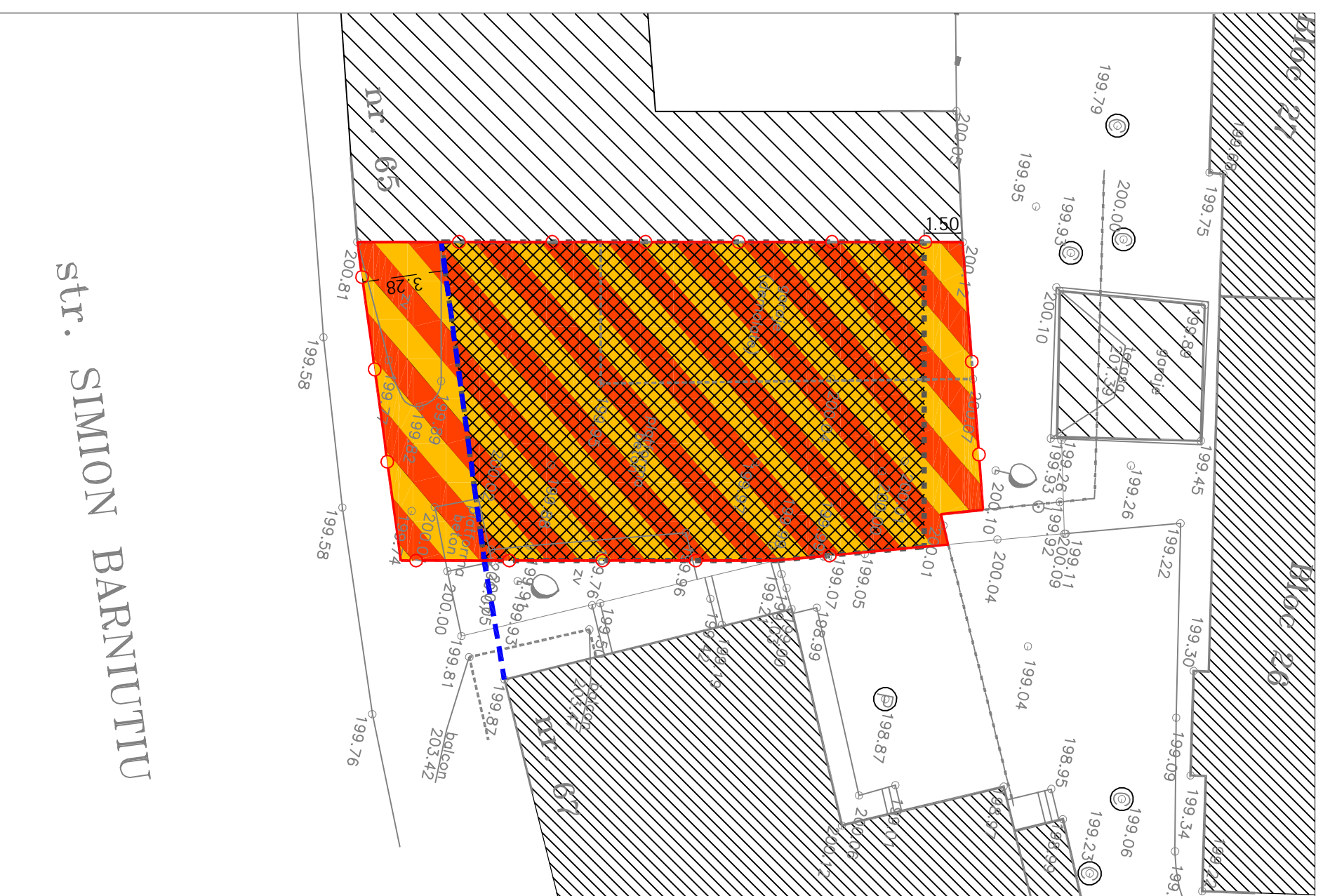

str. SIMION BARNUTIU

Timisoara, strada Memorandului nr. 93, telefon: 0256/294218, 338234499, e-mail: office@studiorarca.ro		beneficiar: S.C. PRO MAREK s.r.l.		pr. nr. 179/2006
<b>studio arca srl</b>		den. lucrare: SPATII COMERCIALE SI LOCUINTE		P.U.D.
		adresa: Timisoara, str. Simion Barnutiū nr. 65 - 67		
SEF PROIECT	arh. Radu GOLUMBA	scara	planse:	
PROIECTAT	arh. Radu GOLUMBA	1:200	REGLEMENTARI URBANE	
DESENAT	arh. Calin PASCU			
VERIFICAT	arh. Claudiu OPRIȚA	lun, 2006		
			plan nr.	03A