

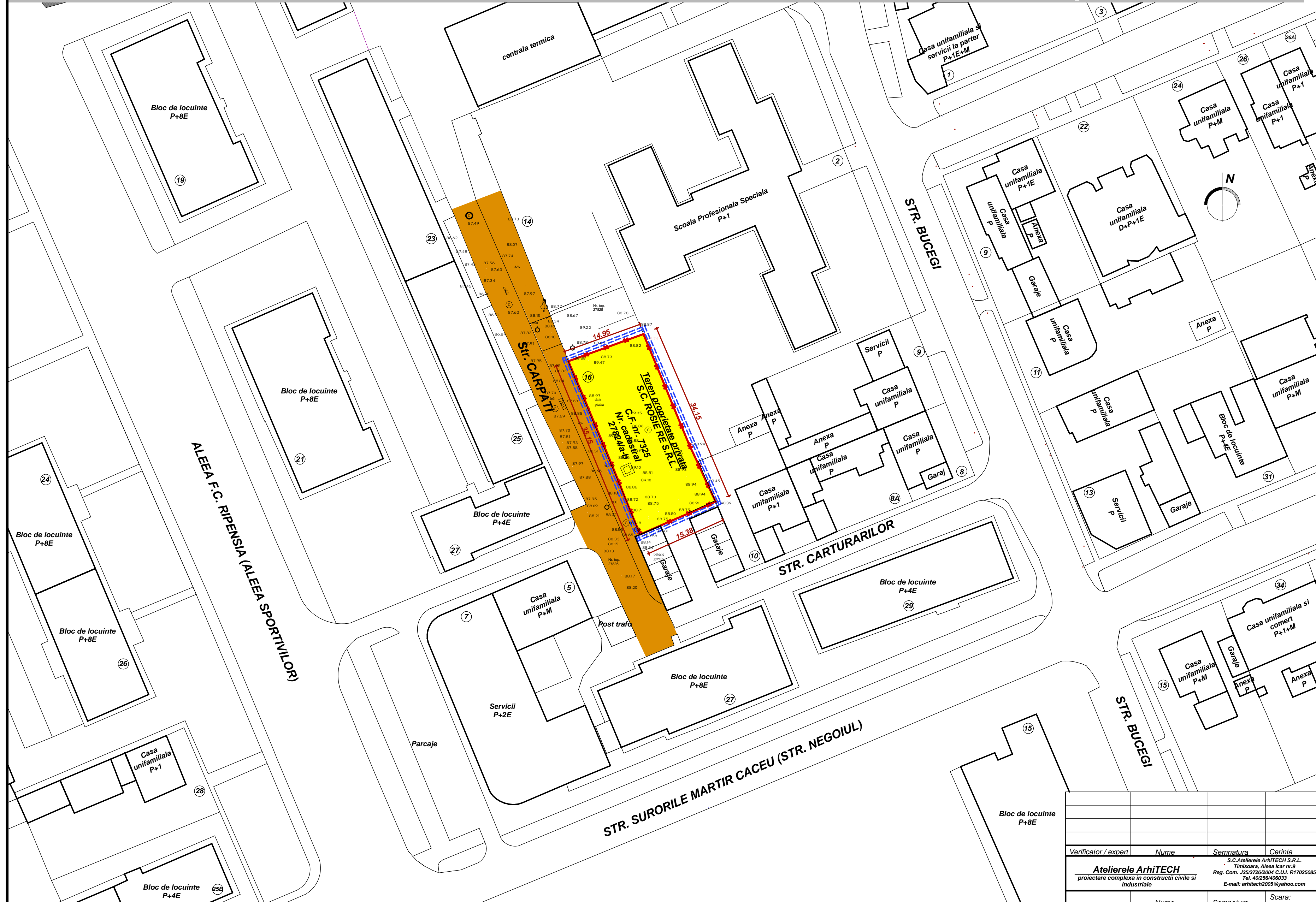



P.U.D. CLADIRE LOCUINTE COLECTIVE P+3E+Er - Str. Carpati nr. 16



LEGENDA:

-  limita zonei studiate
-  limita de proprietate
-  teren proprietate privata (persoane fizice)
-  teren proprietate publica

Plan de incadrare



Cladire locuinte colective
Regim de inaltime: P+3E+Er
H max +15.00m fata de C.T.S.

P.O.T. max. = 40%
C.U.T. max. = 2.8

1 loc parcare/ apartament

Verificator / expert	Nume	Semnatura	Cerinta	Referat / Expertiza Nr. / Data
Atelierele ArhiTECH S.C. Atelierele ArhiTECH S.R.L. Timisoara, Aleea Icar nr.9 Reg. Com. J253702/094 C.I.U. R17025085 Tel. 40256406033 E-mail: arhitech2005@yahoo.com				Beneficiar: S.C. ROSIE RE S.R.L. Amplasament: Timisoara, Str. Carpati nr. 16
Sef proiect: Razvan Negrisanu Proiectat: Eugen Filip Desenat: Craciun Novella			Scara: 1:500 Data: Sept. 2007	Titlu proiect: CLADIRE LOCUINTE COLECTIVE - PUD - Titlu plansa: PROPRIETATEA ASUPRA TERENURILOR
				Proiect nr.: 84/ CAR1/ 06 Faza: PUD Plansa nr.: 04 - A

P.U.D. CLADIRE LOCUINTE COLECTIVE P+3E+Er