

CONDOMINIUM CU DESTINATIA DE LOCUINTE PLURIFAMILIALE SI FUNCTIUNI COMPLEMENTARE

PLAN DE SITUATIE
 PROPUNERI DE MOBILARE
 SC. 1:500

DATE GENERALE AMPLASAMENT:
 Timisoara, Cal.Torontalului, str. Gr. Alexandrescu
 nr. top. 23486/6, 23486/5 /1, 23486/5 /2, 23486/4
 CF. nr. 99994,CF. nr. 99995,CF. nr. 100757,CF. nr. 99996
 SUPRAFATA CONSTRUITA PROPU SA - 4658mp
 SUPRAFATA DESFASURATA PROPU SA - c.c.a.4500mp
 ALINIAREA-retragere propusa din aliniament:

- 3.46m inspre Sabin Evutianu
- 7.00m inspre Augustin Coman
- 3.75m inspre Gr. Alexandrescu
- 9.00m fata de limita terenului cu nr. top. 23486/3

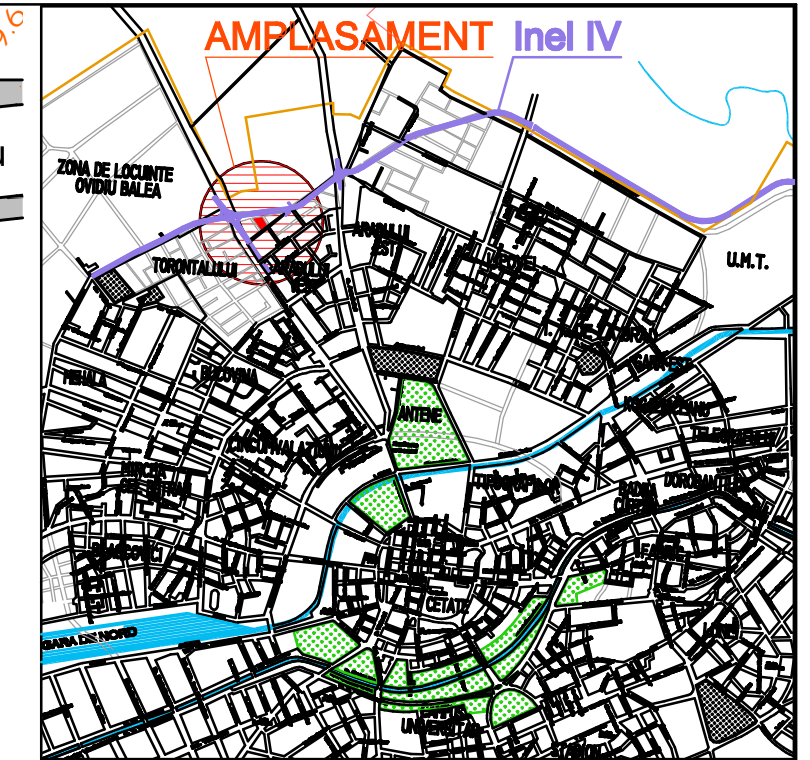
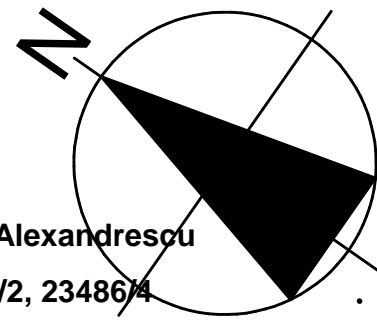

- LEGENDA:**
- Limita proprietate
 - Limite parcele conform CF
 - Limita teren studiat in PUD
 - Constructii propuse
 - Propunere drum preluata din documentatii aprobate
 - Alee acces
 - Spatii verzi in perimetrul Condominiului
 - Circulatii verticale ale constructiilor propuse
 - S+P+6+M** Regim maxim de inaltime

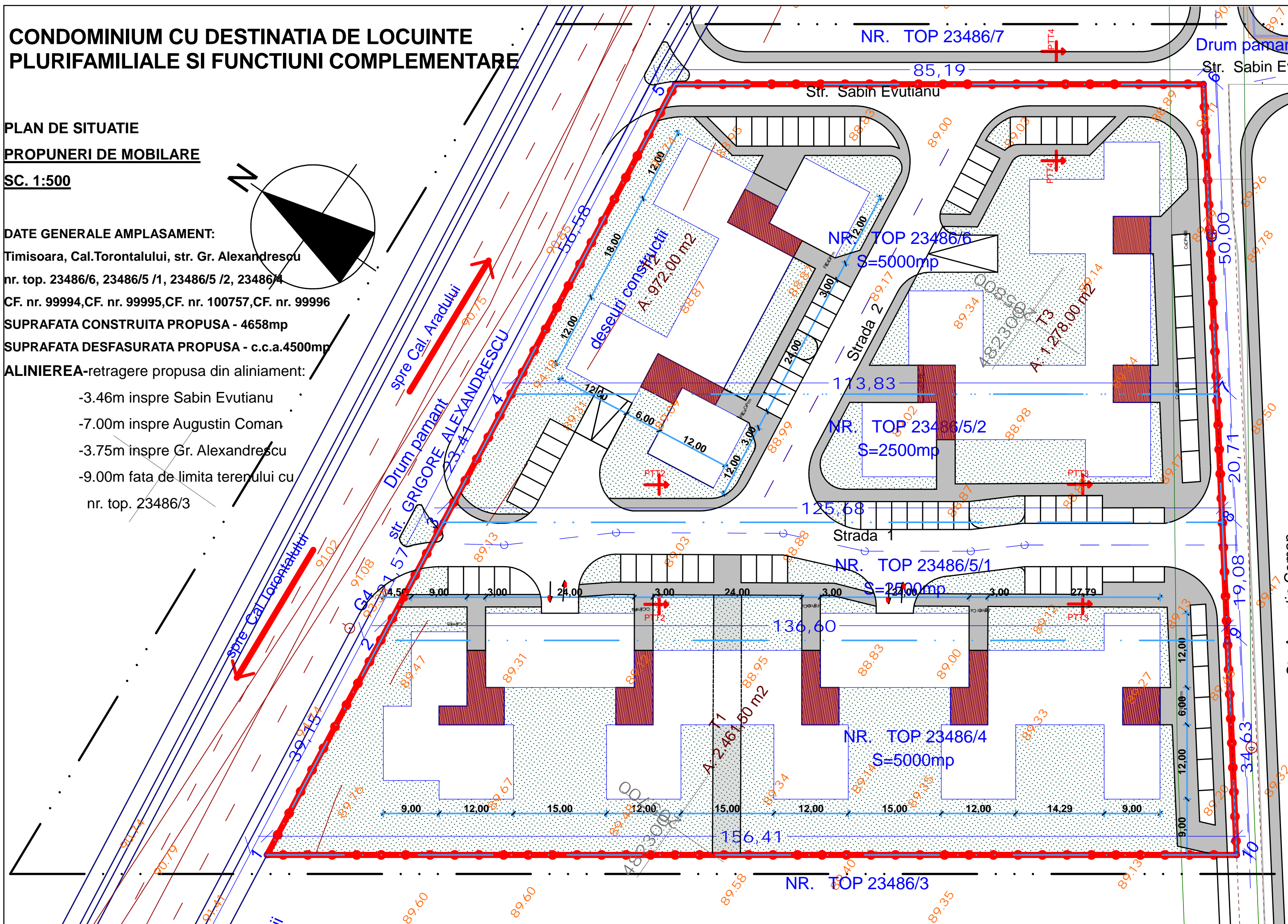

SUPORT TOPOGRAFIC STEREO 70

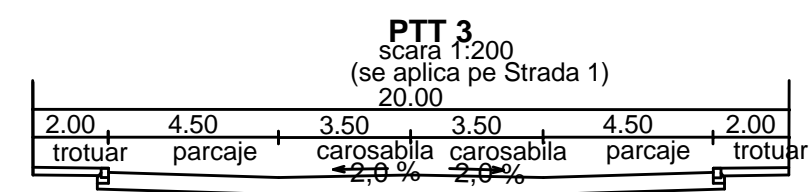
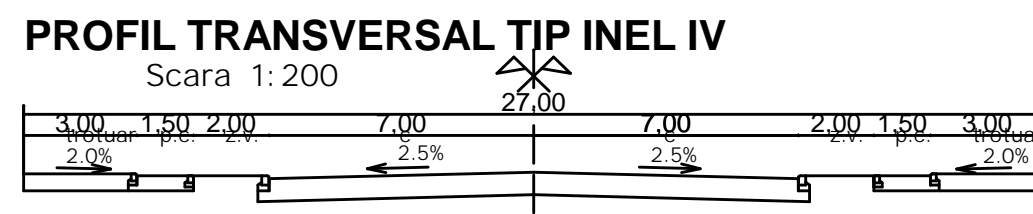
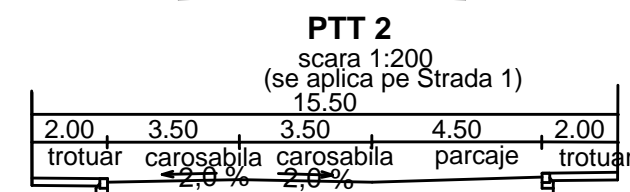
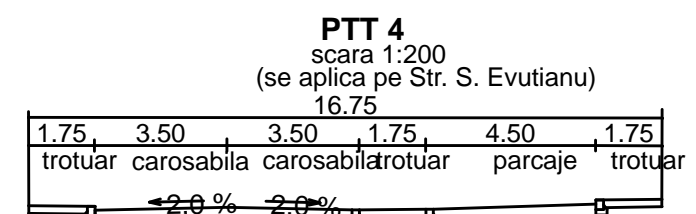
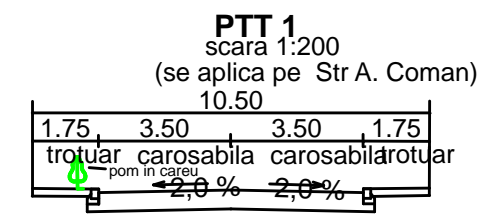

PROIECTANT DE SPECIALITATE:
S.C. CosMunWest S.R.L.
ING. DORU MUNTEANU
ING. SEBASTIAN GRUIA
ING. LINDA MUNTEANU

Verificat/Expert	Nume, Prenume	Cerinte	Semnatura	Nr. Referat	Nr. Raport
PROIECTANT	Birou Individual de Arhitectura			PROIECT :	Pr. nr.5 / 2005
ALMAJAN TITUS GABRIEL				CONDOMINIUM CU DESTINATIA DE LOCUINTE	Faza
CNP- 1770806020055				PLURIFAMILIALE SI FUNCTIUNI COMPLEMENTARE	P.U.D.
Sef proiect : arh. Gabriel Almajan				Ampl. : Timisoara, Cal. Torontalului, str.Gr.Alexandrescu	mar 2006
Proiectant atestat R.U.R.:Brihacescu L.					
Proiectant: arh. Gabriel Almajan				Beneficiar : S.C. Timcon S.A.	sc. 1:500
Desenat : arh.con.Institoris Karina				Plansa : Propuneri mobilare	Pl. nr. 05A