

PUZ - LOCUINTE COLECTIVE, SERVICII, COMERT

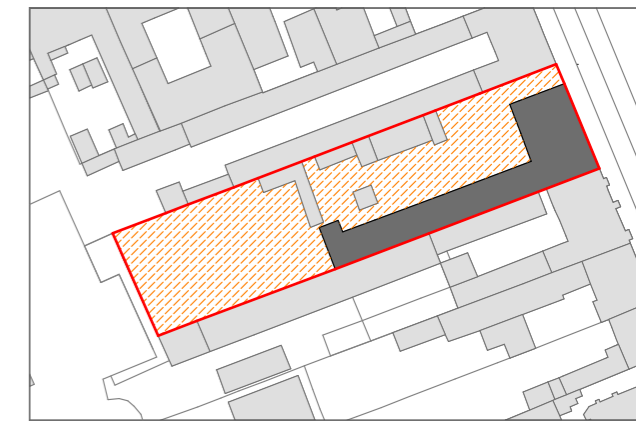

1 cladiri tip "L" - ocupa frontul stradal si o latura a parcelei, cu calcan.

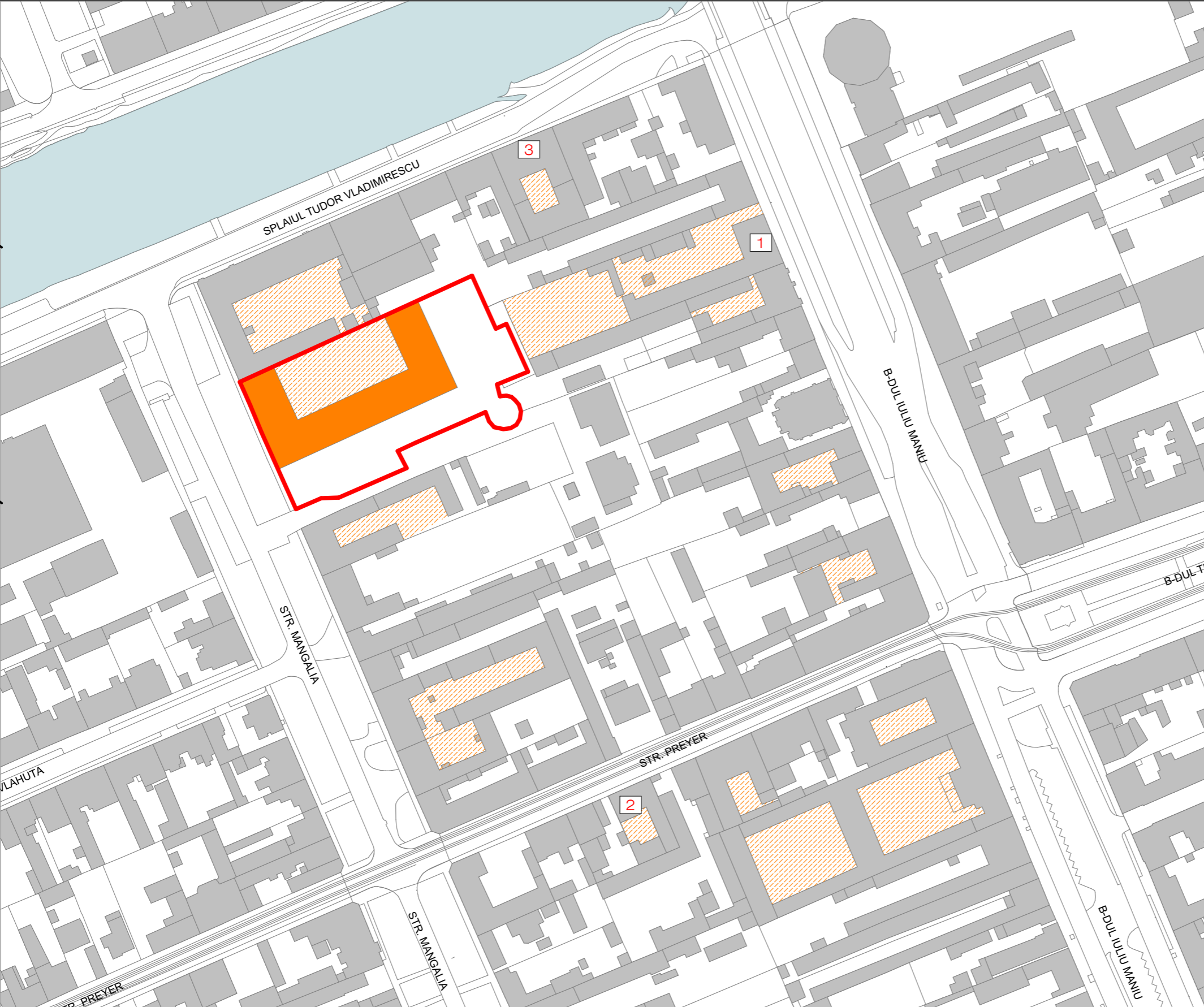

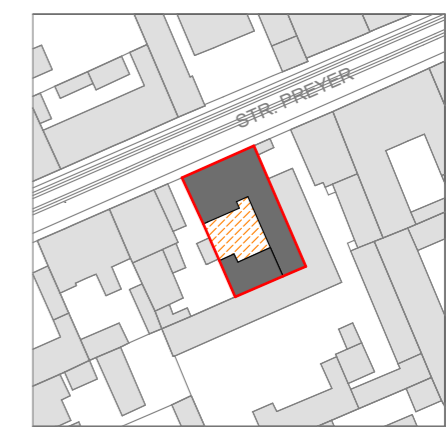

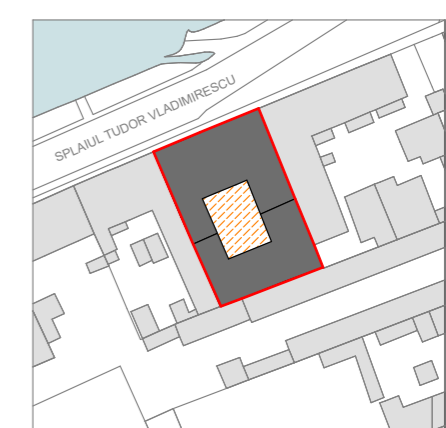
2 cladiri tip "C" - ocupa frontul stradal, o latura a parcelei si latura posterioara, cu calcan formand curti interioare.



3 cladiri care ocupa perimetral toate laturile parcelei, cu calcan formand curti interioare.

MODUL DE OCUPARE A PARCELELOR IN CVARTAL

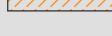
-  cladiri existente
-  cladiri - tipologii existente omogene cu fronturi continue la strada si dezvoltate in adancime, cu calcan pe una sau pe cele doua limite laterale formand curti interioare
-  cladire - tipologie propusa cu front continuu la strada si dezvoltata in adancime pe trei laturi formand o curte interioara

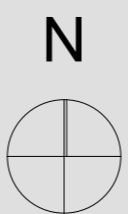

studioarca

Timisoara, strada Tosca nr.14, J35/234/99, e-mail office@studioarca.ro

| | | | |
|-------------|----------------------|-----------|---|
| SEF PROIECT | arh. Radu GOLUMBA | scara: | plansa: |
| PROIECTAT | arh. Mihaela RUSULET | 1:1500 | POSSIBILITATI DE MOBILARE. STUDIUL MOD DE OCUPARE A PARCELELOR IN CVARTAL |
| DESENAT | arh. Mihaela RUSULET | | |
| VERIFICAT | arh. Claudiu OPRITA | feb. 2018 | |

beneficiar: TIMCO S.A
den. lucrare: P.U.Z.-Locuinte colective, servicii, comert
adresa: str. Mangalia nr. 66-72, Timisoara

pr. nr. 335/2017

faza PUZ

plansa nr. 04.1 A

format A3