







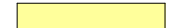

**PUD - Extindere hala existenta**  
**Beneficiar: SC BLEU ELECTRIQUE ROMANIA SRL**  
**Amplasament: str. Ovidiu Cotrus, nr. 26/A, CF 5069 Freidorf, Cad. Cc1366/1/4/d**

**Legenda**

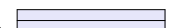
-  Limita zona studiata
-  Limita parcela aflata in proprietatea beneficiarului
-  Zona ce ramane in proprietatea privata a persoanei juridice
-  Drum privat
-  Zona cu servitute de trecere auto si cu pasul in favoarea proprietarului Cc1366/1/4/d
-  LEA 110KV
-  Zona protectie LEA
-  Drum public de interes local
-  Teren pentru largirea drumului public existent

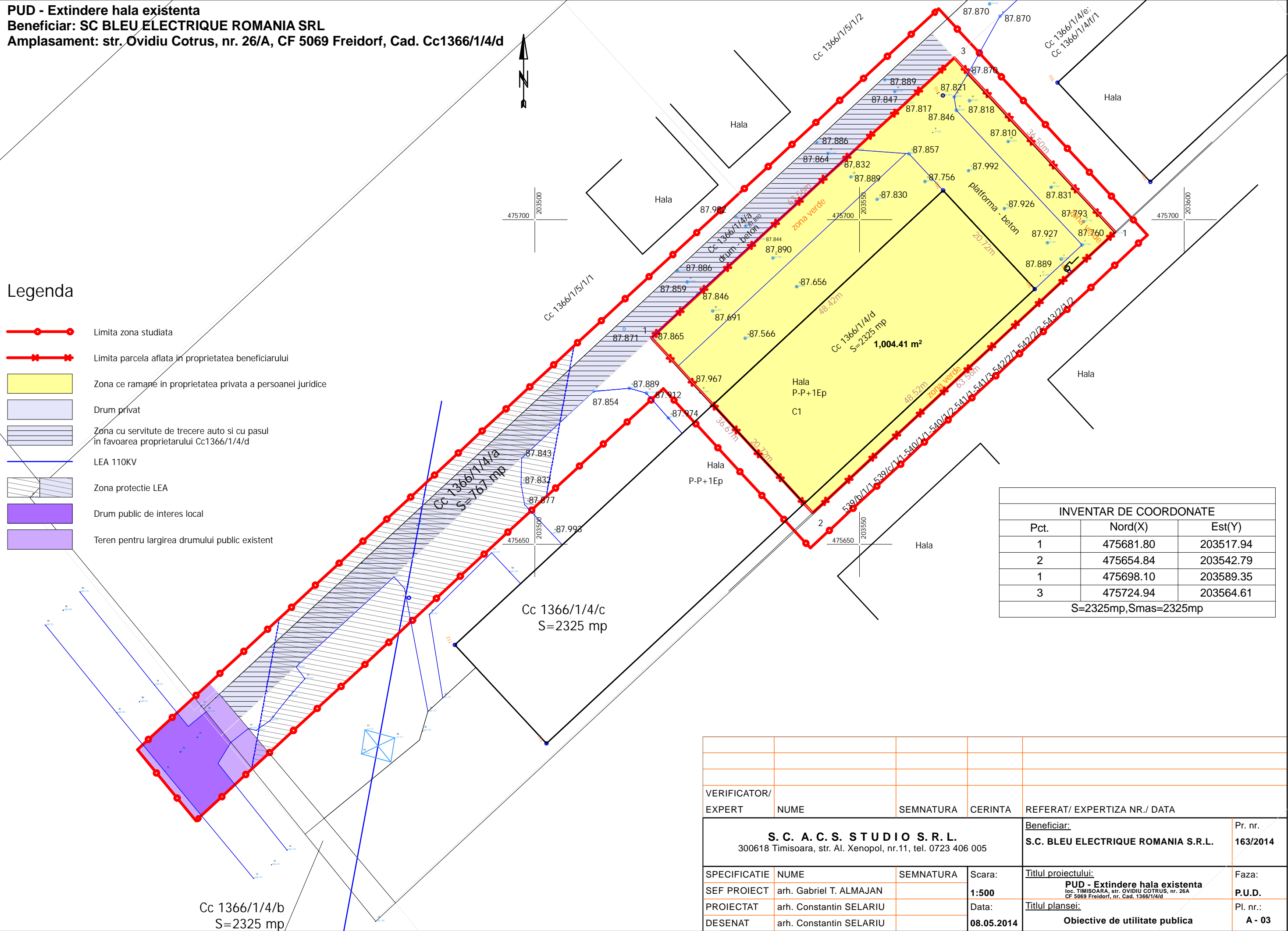

INVENTAR DE COORDONATE		
Pct.	Nord(X)	Est(Y)
1	475681.80	203517.94
2	475654.84	203542.79
1	475698.10	203589.35
3	475724.94	203564.61
S=2325mp, S <sub>mas</sub> =2325mp		

VERIFICATOR/ EXPERT		NUME	SEMNATURA	CERINTA	REFERAT/ EXPERTIZA NR./ DATA
<b>S. C. A. C. S. STUDIO S. R. L.</b> 300618 Timisoara, str. Al. Xenopol, nr.11, tel. 0723 406 005					Beneficiar: <b>S.C. BLEU ELECTRIQUE ROMANIA S.R.L.</b> Pr. nr. <b>163/2014</b>
SPECIFICATIE	NUME	SEMNATURA	Scara:	Titlul proiectului:	Faza:
SEF PROIECT	arh. Gabriel T. ALMAJAN		<b>1:500</b>	<b>PUD - Extindere hala existenta</b> loc. TIMISOARA, str. OVIDIU COTRUS, nr. 26A CF 5069 Freidorf, nr. Cad. 1366/1/4/d	<b>P.U.D.</b>
PROIECTAT	arh. Constantin SELARIU		Data:	Titlul plansei:	Pl. nr.:
DESENAT	arh. Constantin SELARIU		<b>08.05.2014</b>	<b>Obiective de utilitate publica</b>	<b>A - 03</b>