

Profil Longitudinal : Km 5+600.00 - 6+300.00

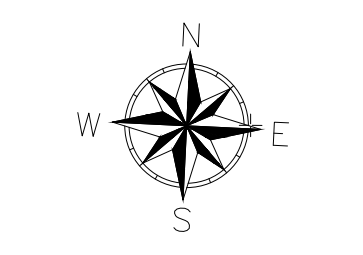

Cote de Nivel	Distanțe Parțiale	Distanțe Cumulate
82.28	5.00	5.000
82.24	5.00	10.000
82.41	5.00	15.000
82.30	5.00	20.000
82.42	5.00	25.000
82.51	5.00	30.000
82.63	5.00	35.000
82.59	5.00	40.000
82.53	5.00	45.000
82.44	5.00	50.000
82.37	5.00	55.000
82.46	5.00	60.000
82.19	5.00	65.000
82.09	5.00	70.000
82.09	5.00	75.000
82.17	5.00	80.000
82.28	5.00	85.000
82.45	5.00	90.000
82.18	5.00	95.000
82.28	5.00	100.000
82.16	5.00	105.000
82.49	5.00	110.000
82.46	5.00	115.000
82.30	5.00	120.000
82.47	5.00	125.000
82.43	5.00	130.000
82.29	5.00	135.000
82.75	5.00	140.000
82.68	5.00	145.000
82.59	5.00	150.000
82.62	5.00	155.000
82.57	5.00	160.000
82.36	5.00	165.000
82.65	5.00	170.000
83.37	5.00	175.000
83.18	5.00	180.000
83.63	5.00	185.000
82.49	5.00	190.000
82.22	5.00	195.000
82.13	5.00	200.000
82.41	5.00	205.000
82.14	5.00	210.000
82.16	5.00	215.000
82.29	5.00	220.000
82.29	5.00	225.000
82.71	5.00	230.000
82.83	5.00	235.000
82.50	5.00	240.000
82.20	5.00	245.000
82.24	5.00	250.000
82.15	5.00	255.000
82.22	5.00	260.000
82.31	5.00	265.000
82.40	5.00	270.000
82.77	5.00	275.000
82.58	5.00	280.000
82.22	5.00	285.000
82.47	5.00	290.000
82.66	5.00	295.000
82.68	5.00	300.000
82.44	5.00	305.000
82.76	5.00	310.000
82.72	5.00	315.000
82.35	5.00	320.000
82.46	5.00	325.000
82.58	5.00	330.000
82.50	5.00	335.000
82.39	5.00	340.000
82.61	5.00	345.000
82.76	5.00	350.000
82.67	5.00	355.000
82.45	5.00	360.000
82.44	5.00	365.000
82.46	5.00	370.000
82.28	5.00	375.000
82.50	5.00	380.000
82.50	5.00	385.000
82.85	5.00	390.000
82.61	5.00	395.000
82.42	5.00	400.000
82.56	5.00	405.000
82.50	5.00	410.000
82.58	5.00	415.000
82.76	5.00	420.000
82.58	5.00	425.000
82.76	5.00	430.000
82.70	5.00	435.000
82.54	5.00	440.000
82.61	5.00	445.000
82.23	5.00	450.000
82.22	5.00	455.000
82.49	5.00	460.000
82.64	5.00	465.000
82.71	5.00	470.000
82.68	5.00	475.000
82.69	5.00	480.000
82.69	5.00	485.000
82.60	5.00	490.000
82.92	5.00	495.000
82.64	5.00	500.000
82.71	5.00	505.000
82.68	5.00	510.000
82.69	5.00	515.000
82.60	5.00	520.000
82.60	5.00	525.000
82.51	5.00	530.000
82.47	5.00	535.000
82.40	5.00	540.000
82.43	5.00	545.000
82.57	5.00	550.000
82.60	5.00	555.000
82.53	5.00	560.000
82.43	5.00	565.000

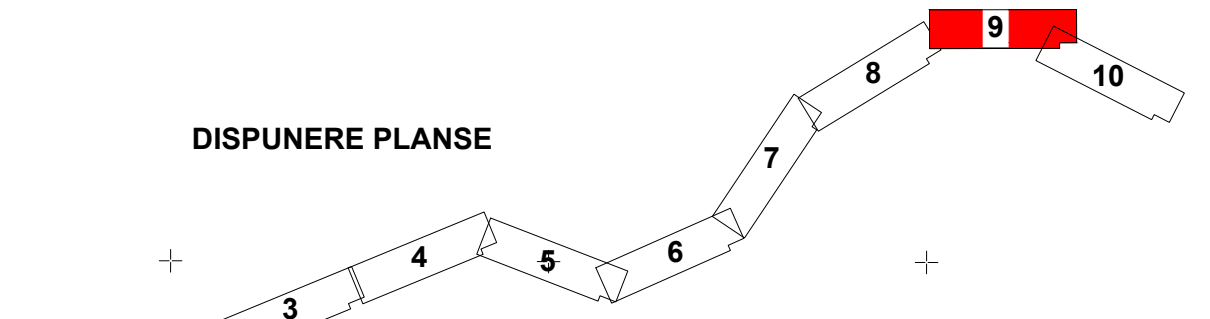


TITLU PLANSA		PLAN GENERAL DE SITUAȚIE		EXECUTANT	
SCARA: 1:500		DATA: 19.08.2016		S.C. TOPOMINIERA S.R.L.	
MASURAT		FLANSA 9		BENEFICIAR	
DESENAT		VERIFICAT		S.C. TRANSPROIECT 2001	
SISTEM DE PROIEȚIE: STENOGRAFICE 1:70		COTA DE REFERINȚĂ PENTRU NIVELMENT: MAREA NEAGRĂ 1975		FILIALA CONSTANȚA S.R.L.	
PROIECT		Ridicări Topo-Hidrografice pe		Canalul Bega-Timoara	

